

Formula Student Germany 2024

Team Briefing, Friday August 16th



16.08.2024

General Information



- Vehicle with wings: two “wingmen” needed (one on each side)
- **Putting Stickers on Property of the Hockenheimring is prohibited!**
 - Teams that are caught applying stickers will pay for the cost of professional cleaning of the respective areas.
 - Our tip - cleaning agents available at the Würth booth are perfect for removing adhesive remains.

Panoramic Picture

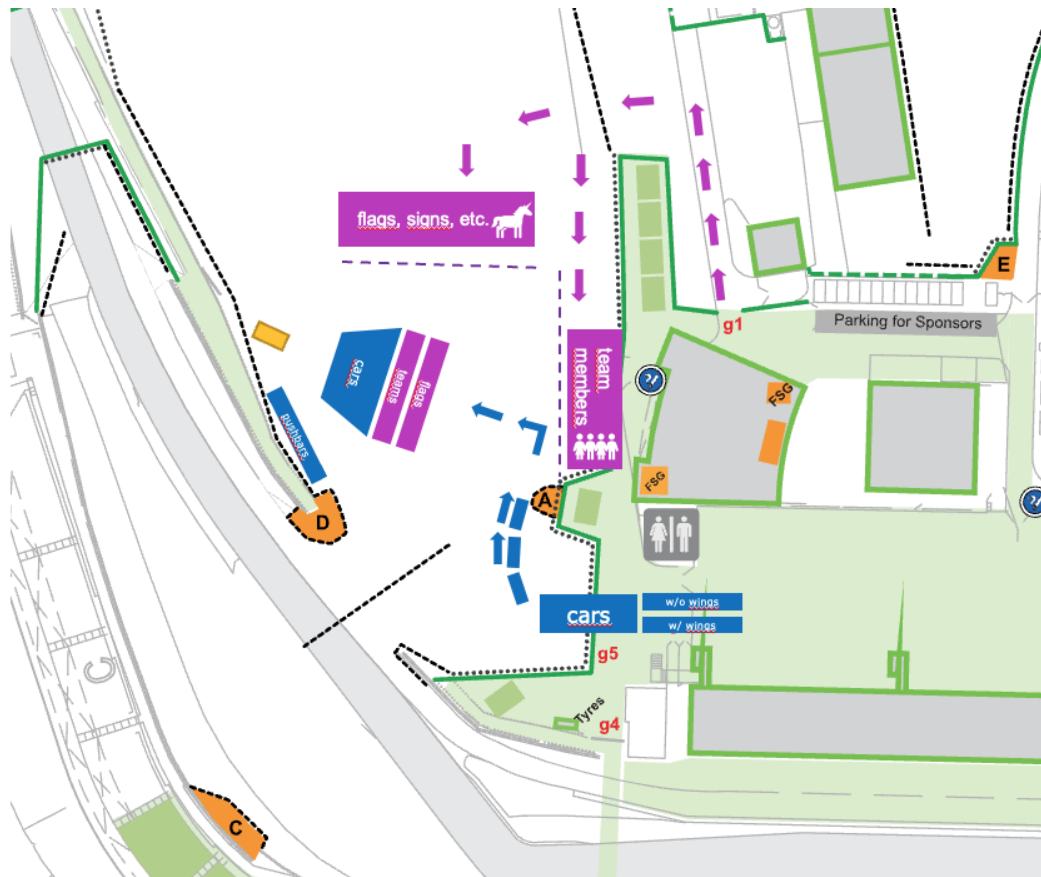

- Entrance cars: gate 5
- Entrance team members: gate 1
- **Start staging for vehicles: 12:45**
- **Start staging team: 13:15**
- **Make sure to be punctual**
- Flags are allowed but will be staged as last in the back of the picture
- Please, follow the Official's instructions

EBS Test



- On request at the Race Control Container
- Get in contact with the Technical Inspectors
- EBS Test on request possible: 9:00 – 12:45 and 13:45 – 19:00

How-to-dynamics



- Arrive at the event when you wish to do your run – no hanging around pointlessly
- Speculating in “late run” for certain track conditions is YOUR gamble.
- Ready to race = Belts buckled, helmet & gloves on, vehicle in ready condition.
- Scrutineers will do spot checking at any time
- Handheld umbrellas only. No tents, tarps, pavilions etc.
- We will handle the cleanliness of the dynamic area. Don't bring brooms.
- Track Condition is declared by signs at Race Control Container

Closing Time Gong!



- End of session will be "announced" via gong
- Vehicle at entry that already received green flag is last contender allowed to run
 - Green flag must have been waved prior to the Audio signal
 - 2nd runs are not allowed afterwards
 - Reruns will be granted after audio signal if applicable

Dynamics - Practice area

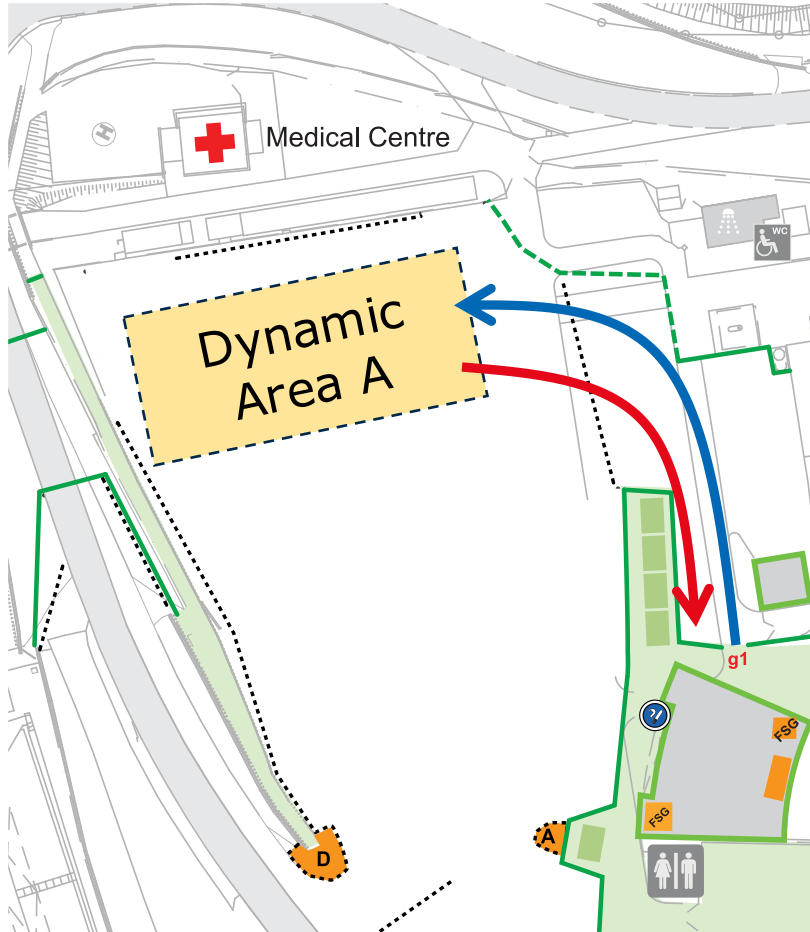

Practice Area (DV + MV)

- Dynamic A: 9:00 to 12:45 and 13:45 to 19:00
- Access and Exit via gate 1
- Track time 3 - 5 min / run
- Running order is list based, sign in at the marshals
- After testing please take all your equipment with you

Dynamics - Practice area

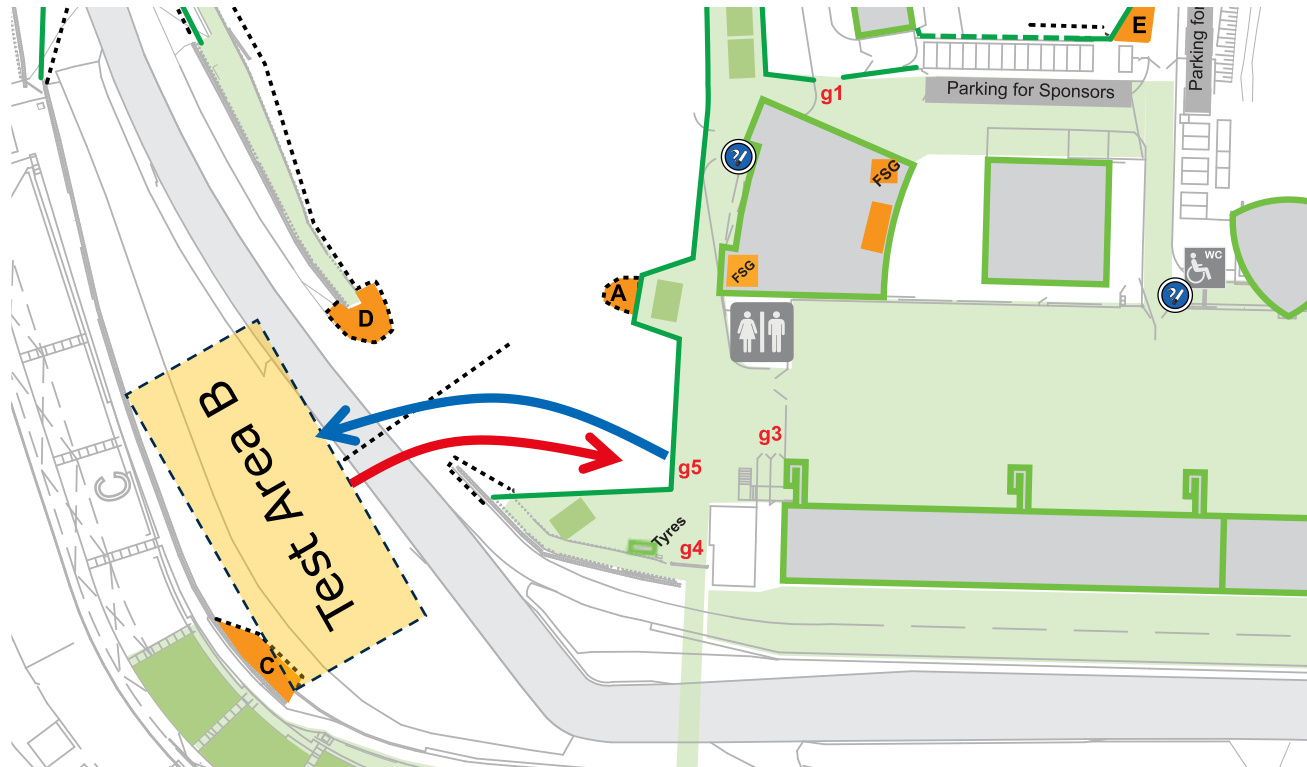

Practice Area (MV only)

- Test Area B: 9:00 to 12:45 and 13:45 to 19:00
- Access and Exit via gate 5
- Track time 3 - 5 min / run
- Running order is list based, sign in at the marshals
- After testing please take all your equipment with you

Dynamics – Manual Skidpad

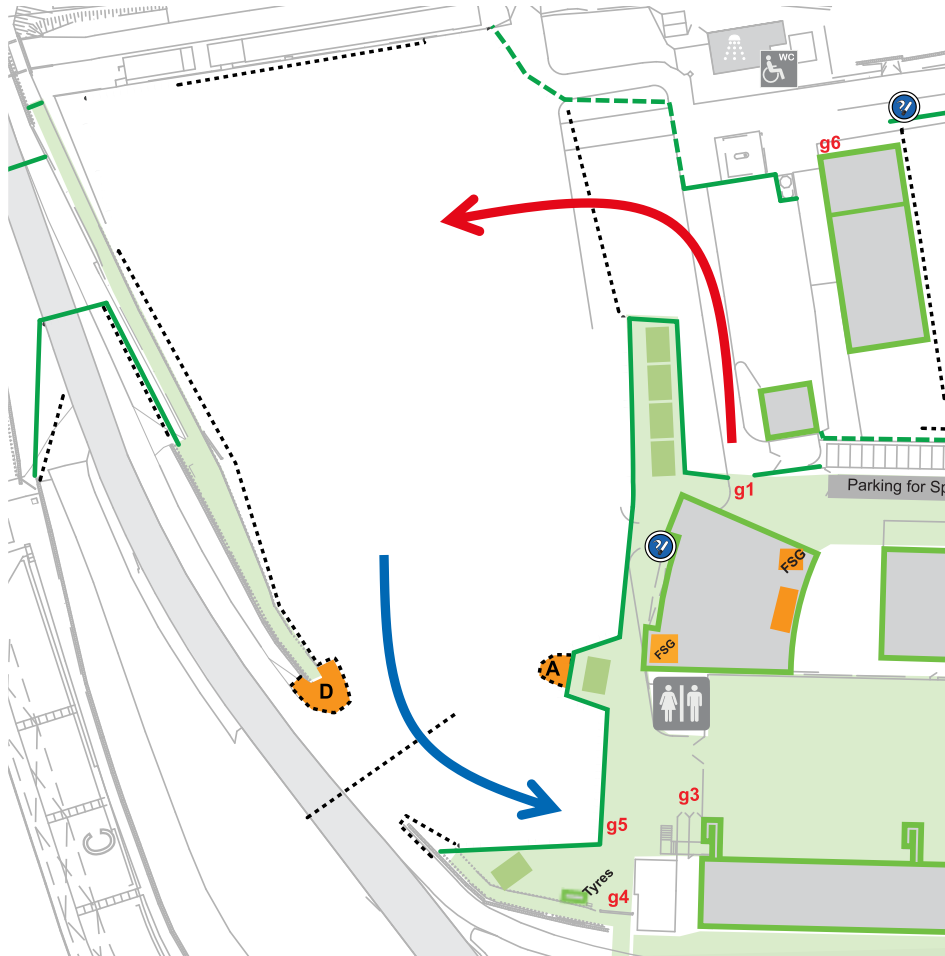

Manual Skidpad

- Dynamic B: 9:30 to 12:30 (Queue opens 9:00)
- Entry via gate 1
- Exit via gate 5

Dynamics – Manual Skidpad



- 2 runs per team, one driver
- 2 laps to the right, 2 laps to the left.
- Two lane queue – one for “1st attempt” and one for “2nd attempt”
- Teams on their 1st attempt will be given priority

- **Penalties**
 - Cone down or out (DOO): 0.2 sec
 - Off course (OC): DNF
 - Wrong number of laps: DNF
 - Wrong direction: DNF

Dynamics – Driverless Acceleration



Driverless Acceleration

- Start / Finish Line: 9:00 to 12:30 (Queue open: 8:30)
- Entry and Exit via gate 2

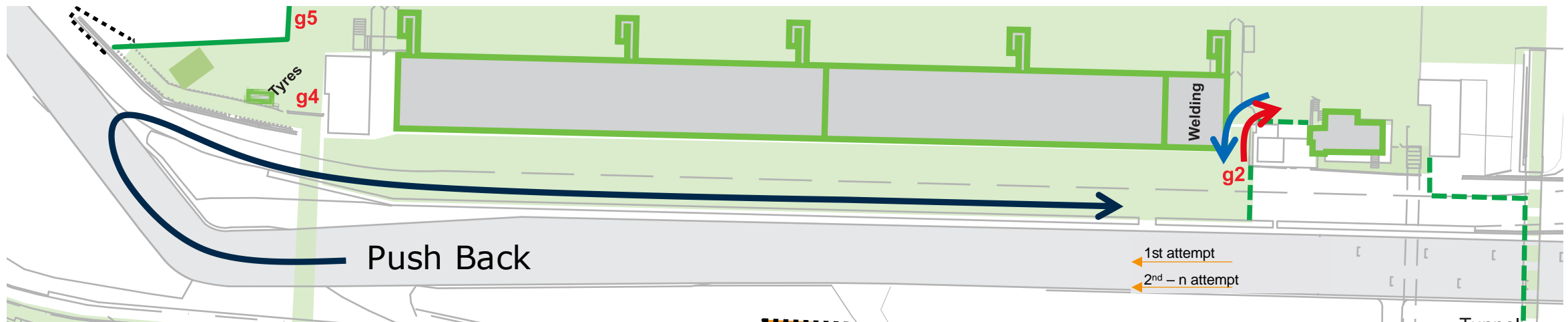

Dynamics – Driverless Acceleration



- 2 runs per team
- Two lane queue – one for “1st attempt” and one for “2nd attempt”
- Teams on their 1st attempt will be given priority
- There will be a shuttle for DV team members to pick up the car after the run

- **Penalties**
 - cone down or out (DOO): 2 sec
 - off course (OC): DNF
 - unsafe stop (USS): DNF

Dynamics – Driverless Autocross

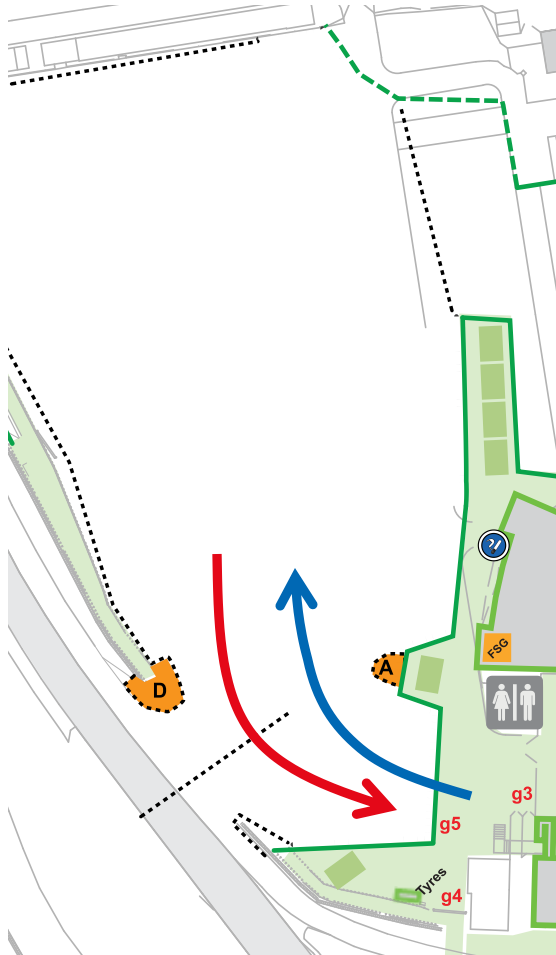

Driverless Autocross

- Thanks to the Driverless teams for the feedback about the track layout. We will provide our feedback on your thoughts at the beginning of the course walk.
- Course Walk: 15:00 to 15:30
- Dynamic B: 16:00 to 19:00 (Queue opens: 15:30)
- Entry and Exit via gate 5
- We planned enough time - you are responsible to show up in time
- In the last hour there might be long queues
- Please keep in mind rules D2.6 & D9.1.16

Dynamics – Driverless Autocross



- 2 runs per team
- Two lane queue – one for “1st attempt” and one for “2nd attempt”
- Teams on their 1st attempt will be given priority

- Track length: 341m

- **Penalties**
 - cone down or out (DOO): 2 sec
 - off course (OC): 10 sec
 - unsafe stop (USS): DNF

Dynamics – Manual Acceleration



Manual Acceleration

- Start / Finish Line: 14:45 to 17:45 (Queue opens: 14:15)
- Entry & Exit via gate 2

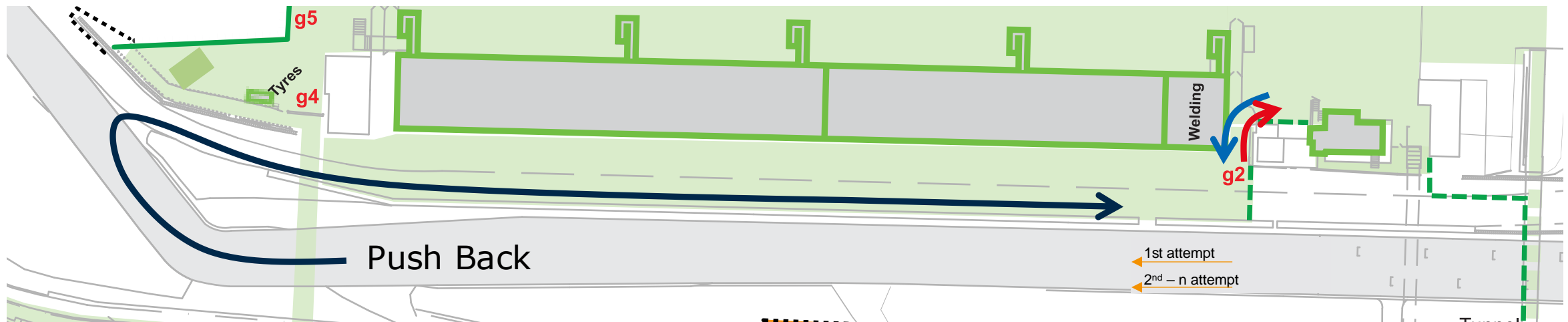

Dynamics – Manual Acceleration



- 2 runs per team, one driver
- Two lane queue – one for “1st attempt” and one for “2nd attempt”
- Teams on their 1st attempt will be given priority
- The car drives under own power from the queue to the start line
- Car is staged by the starter
- Time starts on line-crossing, not the flag drop
- Follow signs for 2nd run or exit
- **Penalties**
 - cone down or out (DOO): 2 sec
 - off course (OC): DNF
 - unsafe stop (USS): DNF

Manual Skidpad & Acceleration



Flags



Start your run



Stop your car immediately but safe wherever you are; wait for instructions